

ORIGINAL: Not to be removed from the Department of Land Administration.

Application H275246

VOLUME FOLIO
2176 98
IN THE REGISTER

Volume 2176 Folio 97

WESTERN



AUSTRALIA

CERTIFICATE OF TITLE
UNDER THE "TRANSFER OF LAND ACT, 1893" AS AMENDED



ORIGINAL CERTIFICATE OF TITLE

ORIGINAL CERTIFICATE OF TITLE

ORIGINAL CERTIFICATE OF TITLE

ORIGINAL CERTIFICATE OF TITLE

Superseded - Copy for Sketch Only

ORIGINAL CERTIFICATE OF TITLE

ORIGINAL CERTIFICATE OF TITLE

ORIGINAL CERTIFICATE OF TITLE

ORIGINAL CERTIFICATE OF TITLE

The person described in the First Schedule hereto is the registered proprietor of the undermentioned estate in the undermentioned land subject to the easements, encumbrances and notices shown in the Second Schedule hereto.

Dated 10th November, 1999

J. Hyle
REGISTRAR OF TITLES

ESTATE AND LAND REFERRED TO

Estate in fee simple in portion of Sussex Location 815 and being Lot 703 on Diagram 98315, delineated on the map in the Third Schedule hereto, limited however to the natural surface and therefrom to a depth of 60.96 metres.

FIRST SCHEDULE (continued overleaf)

~~Neville Robert Veitch and Kerrie Aileen Veitch both of Post Office Box 281, Margaret River, as joint tenants of one undivided half share, and Edward Martin Stucken and Pamela Esther Stucken both of Post Office Box 367, Margaret River, as joint tenants of one undivided half share, as tenants in common~~

SECOND SCHEDULE (continued overleaf)

1. Subject to special conditions contained in Crown Grant Vol. 1044 Fol. 979.
2. TRANSFER F638126 contains a restrictive covenant.
3. EASEMENT for Sewerage purposes created on Diagram 98315 under Section 27A TP&D Act.

THIRD SCHEDULE

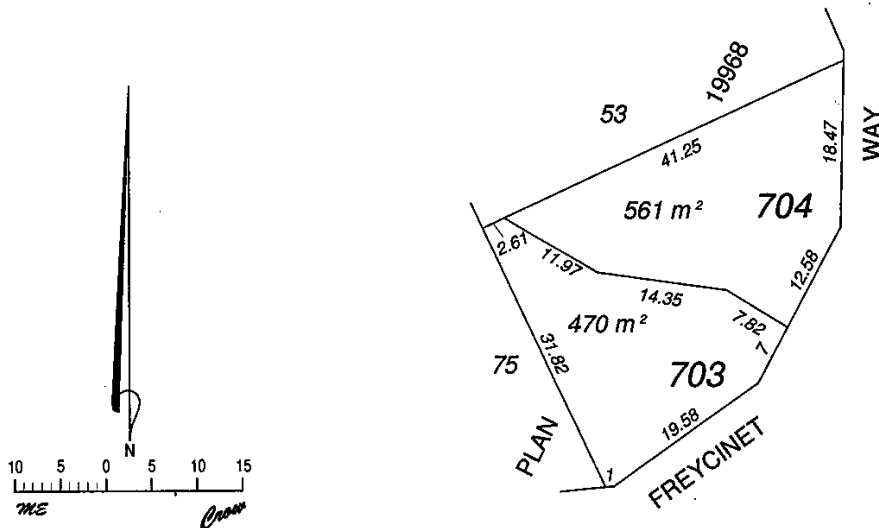

NOTE: Entries may be affected by subsequent endorsements.

FIRST SCHEDULE (continued) NOTE: ENTRIES MAY BE AFFECTED BY SUBSEQUENT ENDORSEMENTS

PARTICULARS	INSTRUMENT NATURE		REGISTERED NUMBER	REGISTERED	TIME	SEAL & INITIAL
	NATURE	NUMBER				
Neville Robert Veitch and Kerrie Aileen Veitch both of Post Office Box 281, Margaret River, as joint tenants. Jeffrey Laurence Smead of Post Office Box 631, Margaret River. The correct address of the registered proprietor is now <u>52 Freycinet Way, Margaret River.</u>	Transfer	H275248	10.11.99	8.14		
	By	H340067	18:1.00	15.47		
		H459108	31.5.00	8.07		

SECOND SCHEDULE (continued)

REGISTERED or LODGED	TIME	SEAL & INITIAL	CANCELLATION		REGISTERED or LODGED	SEAL & INITIAL
			NATURE	NUMBER		
31.5.00	8.07					
<u>Mortgage H459108 to National Australia Bank Ltd.</u>						