

PLAN 17368

P 017368 F 01



LOCAL GOVERNMENT ACT  
ALL ROADS WITHIN THE GREEN  
BORDER ARE NOW DEDICATED.

LOCAL GOVERNMENT ACT  
ALL ROADS WITHIN THE GREEN  
BORDER ARE NOW DEDICATED.

P.A.W / R.O.W as shown on this Survey  
is amended to Lot 155...

Regulation 6 Transfer of Land (Surveys) Regulation 1995

Corr. 1775-2000-01

Date: 15.2.2006

SURVEY OF SUBDIVISION OF PART OF  
SUSSEX LOCATION

724  
TOTAL AREA = 19,4087ha  
FB'S 58593, 58919, 58920

INDEX PLANS DAWSON 2000 0802  
DAWSON 10000 2-1  
CITY 1782-516  
P.A.W. 1870-431

DEDICATED TOWN PLANNING &  
DEVELOPMENT ACT SEC 28 (3)

LIMITED IN DEPTH TO 60.96 METRES

DEVELOPING TOWN PLANNING &  
DEVELOPMENT ACT SEC 28 (3)

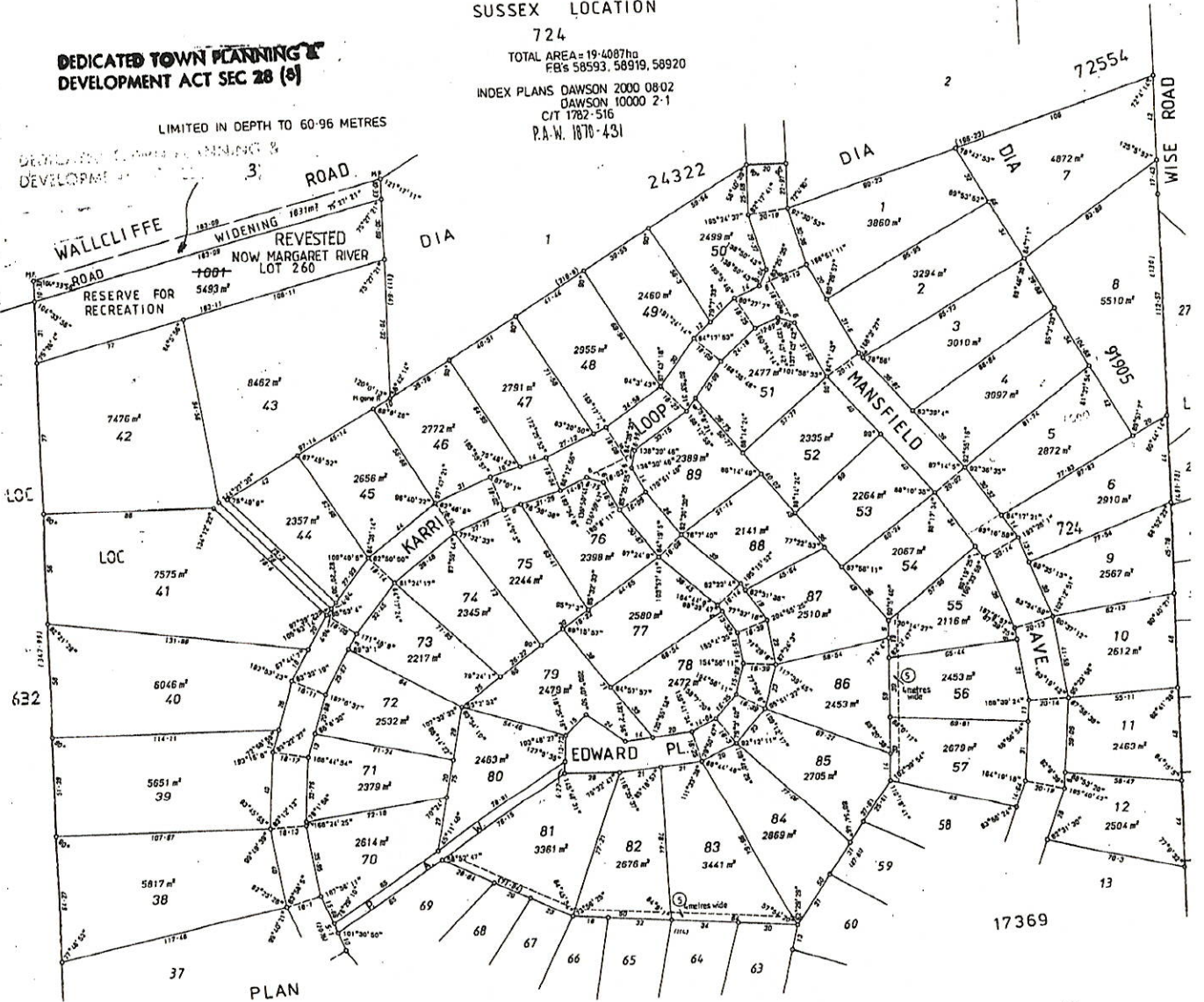

LOT 1001 RESERVE FOR RECREATION AND  
PEDESTRIAN ACCESSWAY TO VEST IN THE CROWN UNDER SEC. 20A.  
OF THE T.P. & D. ACT.

EASEMENT IN FAVOUR OF SHIRE OF AUGUSTA-MARGARET RIVER  
UNDER SECTION 27A T.P. & D. ACT REG 5

SUBDIVISION  
BY EARLY  
ISSUE PROCESS



|   |  |   |   |
|---|--|---|---|
| <b>CERTIFICATE OF SURVEYOR</b><br>JOHN GIUDICE<br>I, JOHN GIUDICE, hereby certify that<br>(a) this survey was performed by me personally (or under my personal supervision, inspection and direct control) in strict accordance with the Licensed Surveyors (Guidance of Surveyors) Regulations, 1984; or<br>(b) this plan is correct, was prepared under my supervision and is the result of calculations from measurements made by me (or under my own personal supervision, inspection and field check), in strict accordance with the Licensed Surveyors (Guidance of Surveyors) Regulations, 1984.<br>Date: 14/3/90<br>Licensed Surveyor | Approved by State Planning Commission<br>79019<br>Chairman<br>Date: 14/3/90  | Examined: R.A. PRA-6<br>Certified Correct: G. S. S.<br>Docket: DIA. 76839<br>R.A.P. | <b>OFFICE OF TITLES</b><br>PLAN No.<br><b>17368</b> |
|   | IN ORDER FOR DEALINGS<br>SUBJECT TO<br>Sec. 28(3) of Local Govt. Act, N<br>Sec. 2A, 71A & 20(1) of T.P. & D. Act<br>For Inspector of Plans & Surveys | APPROVED<br>Inspector of Plans & Surveys<br>27.3.90<br>Date                         | Registered<br>17368<br>14.7.90                      |