

LAND DESCRIPTION  PART LOT 1000 OF SUSSEX LOCATION 2151	ON	CERTIFICATE OF TITLE	FIELD BOOK	DIA 90311 
	PLAN ..... 19255..... DIAGRAM..... INDEX..... BF29(2).10.01, 9.01 PUBLIC.....	VOLUME 2056 FOLIO 351	58594 59094 64367 69421 70640	

LOCAL AUTHORITY: SHIRE OF AUGUSTA-MARGARET RIVER  
LOCALITY: MARGARET RIVER

LIMITED IN DEPTH TO 60.96 METRES

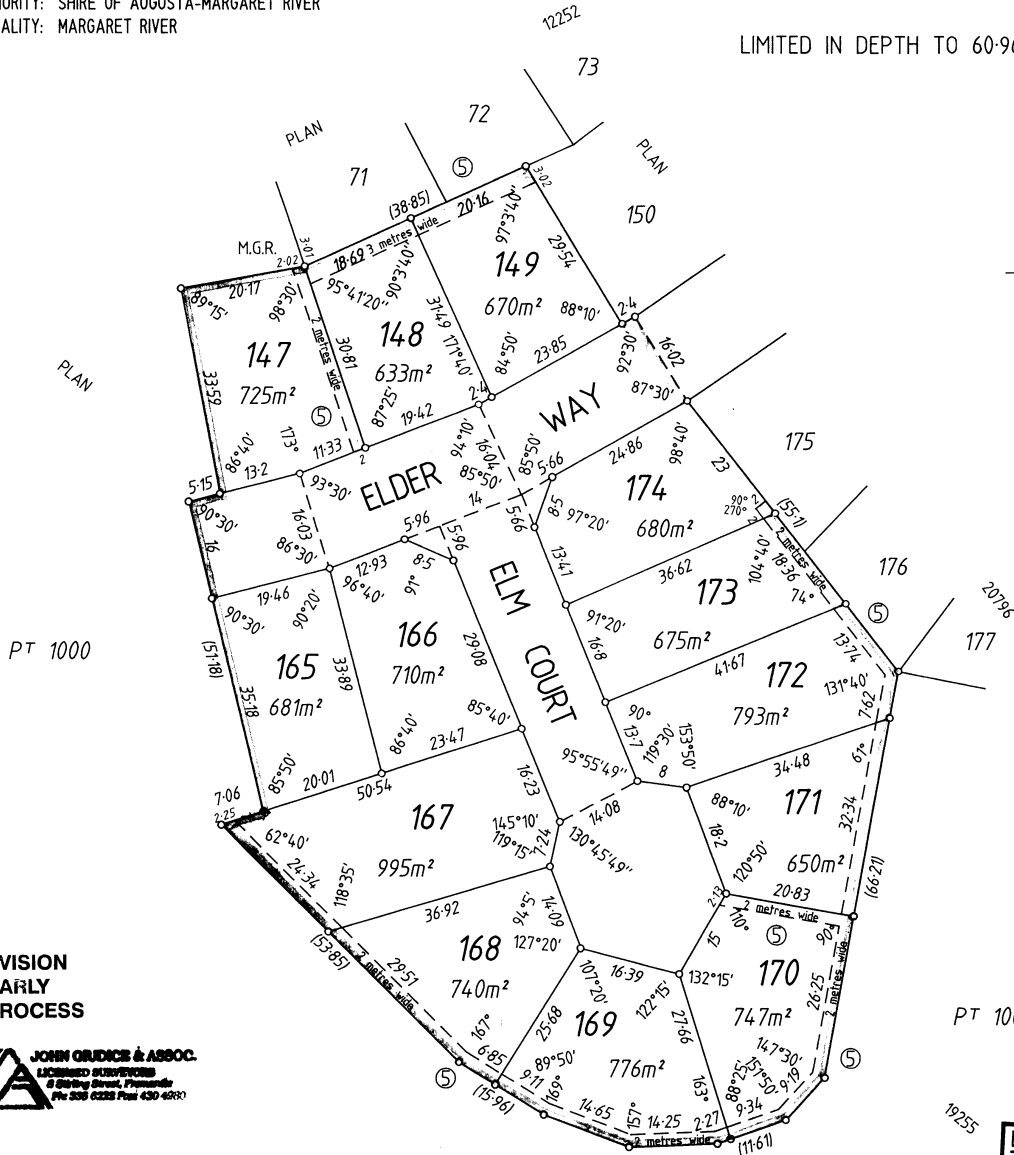



SUBDIVISION BY EARLY ISSUE PROCESS

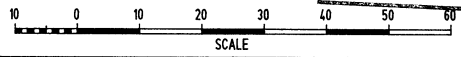

Ⓢ EASEMENT IN FAVOUR OF THE SHIRE OF AUGUSTA-MARGARET RIVER UNDER SECTION 27A OF THE T.P. & D. ACT, REGULATION 5 (DRAINAGE)

LOCAL GOVERNMENT ACT  
ALL ROADS WITHIN THE GREEN BORDER ARE NOW DEDICATED



<b>SURVEYOR'S CERTIFICATE</b> REG 54: I..... hereby certify that: (a) this plan of survey is a correct and accurate representation of the survey carried out by me personally/under my own personal supervision, inspection and field check, and recorded in field books lodged for the purposes of this plan of survey; (b) the measurements are in strict accordance with the Licensed Surveyors (Guidance of Surveyors) Regulations 1961 and in particular regulations 23 and 34 of those regulations; and (c) this survey and this plan of survey are in strict accordance with the requirements of the Licensed Surveyors (Guidance of Surveyors) Regulations 1961 and the relevant law in relation to which it is lodged.		<b>NIGEL J. SIMPSON</b> REG 55D I..... hereby certify that: (a) this plan is correct and was prepared under my supervision and is the result of calculations from measurements made by me personally/under my own personal supervision, inspection and field check as recorded in the field books lodged for the purposes of this plan; (b) the measurements are in strict accordance with the requirements of the Licensed Surveyors (Guidance of Surveyors) Regulations 1961 and in particular regulations 23 and 34 of those regulations; and (c) this plan of survey conforms with the relevant law in relation to which it is lodged.		<b>APPROVED BY WESTERN AUSTRALIAN PLANNING COMMISSION</b> FILE 94660 <i>Lyne Ferraro</i> For Chairman DATE 27-12-95		<b>LODGED</b> DATE 24.11.95 FEE PAID \$ 748 ASSESSMENT No 108733 <b>TYPE OF VALIDATION</b> FULL AUDIT..... LEGAL COMPONENT ✓ DOCKET PLAN/DIAGRAM 19982 CERTIFIED CORRECT <i>f. J. Kowalski</i> 6/12/95 F.S.C. No. 007-1996		<b>SCALE 1:750</b> ALL DISTANCES ARE IN METRES <b>IN ORDER FOR DEALINGS</b> SUBJECT TO SECTION 27A OF THE T.P. & D. ACT AND SECTION 225(5) OF THE L.G. Act. <i>A. Sullivan</i> 8/1/96 FOR INSPECTOR OF PLANS & SURVEYS DATE <b>APPROVED 15.1.96</b> APPROVED INSPECTOR OF PLANS & SURVEYS	
Licensed Surveyor Date <i>N.J. Simpson</i> 24/11/95		Licensed Surveyor Date <i>N.J. Simpson</i> 24/11/95		27 DEC 1995 94660		 <b>DOLA</b> Department of LAND ADMINISTRATION		<b>OFFICE OF TITLES DIAGRAM 90311</b>	

C:\CCAD6\GIUDICE\DWG\_6159