



Application E326010  
Volume 1782 Folio 516

WESTERN



AUSTRALIA

1870 422

# CERTIFICATE OF TITLE

UNDER THE "TRANSFER OF LAND ACT, 1893" AS AMENDED

I certify that the person described in the First Schedule hereto is the registered proprietor of the undermentioned estate in the undermentioned land subject to the easements and encumbrances shown in the Second Schedule hereto.

Dated 27th March, 1990

REGISTRAR OF TITLES



### ESTATE AND LAND REFERRED TO

Estate in fee simple in portion of Sussex Location 724 and being Lot 82 on Plan 17368, delineated on the map in the Third Schedule hereto, limited however to the natural surface and therefrom to a depth of 60.96 metres.

### FIRST SCHEDULE (continued overleaf)

Elizabeth Acres Pty. Ltd. of 62 Mill Point Road, South Perth.

### SECOND SCHEDULE (continued overleaf)

- EASEMENT as shown on Plan 17368.
- MORTGAGE D686826 to Ross Edward Willmott and Michael Ross Willmott, both of Lot 37 Illawarra Avenue, Margaret River. Registered 2.3.88 at 10.21 hrs. Discharged E712634 1.10.91
- MORTGAGE E326008 to Custom Credit Corporation Ltd. Registered 27.3.90 at 12.44 hrs. Discharged E712633 1.10.91

### THIRD SCHEDULE

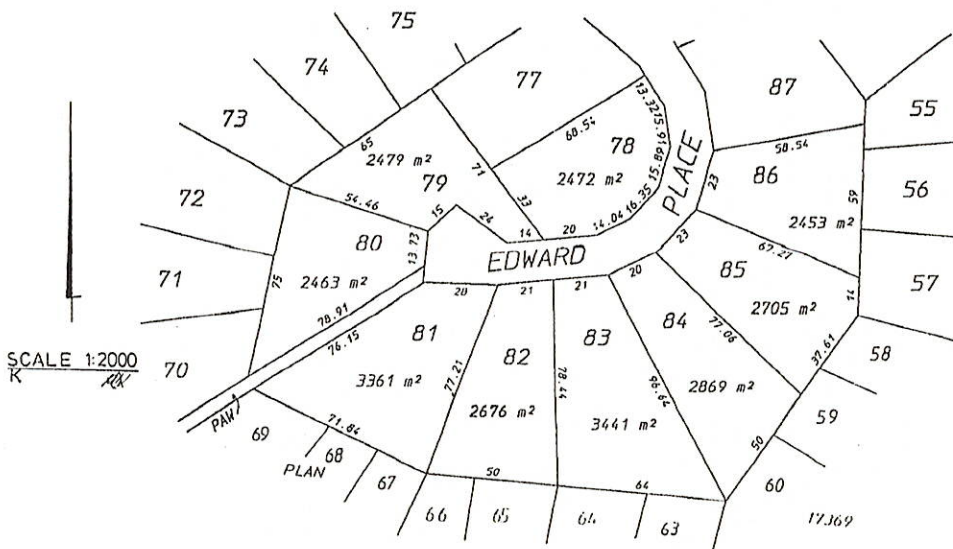

NOTE: ENTRIES MAY BE AFFECTED BY SUBSEQUENT ENDORSEMENTS.

E67590/3/89-20M-L/4664

Superseded - Copy for Sketch Only

Page 1 (of 2 pages) 1870 422  
VOL. FOL.

PERSONS ARE CAUTIONED AGAINST ALTERING OR ADDING TO THIS CERTIFICATE OR ANY NOTIFICATION HEREON

LT. 37

Page 2 (of 2 pages)

FIRST SCHEDULE (continued)		NOTE: ENTRIES MAY BE AFFECTED BY SUBSEQUENT ENDORSEMENTS				
REGISTERED PROPRIETOR	INSTRUMENT NATURE	INSTRUMENT NUMBER	REGISTERED	TIME	SEAL	CERT. OFFICER
Jeremy Peter Wixon and Cheryl Ruth Ellen Wixon, both of 9 Stewart Street, Margaret River, as joint tenants.	Transfer	F399405	17.12.93	8.27		
The correct address of the registered proprietors is now 15 Edward Place, Margaret River.	By	G134438	25.3.96	9.16		
Anne Jones and David Michael Jones both of 15 Edwards Place, Margaret River as joint tenants.	Transfer	G814963	9.6.98	14.16		

SECOND SCHEDULE (continued)		NOTE: ENTRIES MAY BE AFFECTED BY SUBSEQUENT ENDORSEMENTS				
INSTRUMENT NATURE	INSTRUMENT NUMBER	PARTICULARS	REGISTERED	TIME	SEAL	CERT. OFFICER
Mortgage	E712636	to R&I Bank of Western Australia Ltd.	17.12.93	8.27		
Mortgage	F399406	to Westpac Banking Corporation.	25.3.96	9.16		
Mortgage	G134438	to National Australia Bank Ltd.	12.2.01	9.56		
Mortgage	H666218	to Commonwealth Bank of Australia.				

CERTIFICATE OF TITLE VOL. 1870 FOL. 422